

**Documentație cadastrală pentru alipire
Plan de amplasament și
delimitare a corpului de proprietate
situat în Localitatea Cluj Napoca str. Taietura
Turcului nr.47
jud. Cluj**

Beneficiar: Consiliul Judetean Cluj

Executant:

**D&M TOPOGRAFIE
SRL**

Aut. seria B nr. 634



CUPRINS

1. Cerere de solicitare informatii si conventie
 2. Cerere de receptie
 3. Declaratie pe propria raspundere
 4. Extras de carte funciara pentru informare
 5. Descrierea lucrarilor topografice si geodezice
 6. Planul de amplasament si delimitare propunerea de alipire sc. 1:1000
 7. Planul de amplasament si delimitare pentru fiecare imobil rezultat din alipire sc. 1:1000
 8. Fisa de Masuratori
 9. Calculul suprafetelor
-

DESCRIEREA LUCRARI

- 1. Metoda** folosita la masuratori este de radierea
- 2. Aparatura** folosita la masuratori este statia totala Pentax R325NX
- 3. Sistem de coordonate:** sistem de proiectie STEREO'70
- 4. Puncte geodezice Vechi** au fost folosite punctele vechi 212 Taietura Turcului, 215 Steluta si statii vechi din lucrarile anterioare de la TETAROM I. Punctele vechi sunt in stare buna
- 5. Descrierea punctelor noi** nu au fost date puncte noi

Executant :
D&M TOPOGRAFIE SRL
Data decembrie 2008



MEMORIU TEHNIC

- 1. Denumirea lucrării:** Documentatie Cadastrala, Plan de amplasament și delimitare a corpului de proprietate situat in localitatea Cluj Napoca având nr ...138....., din registrul de evidentă propriu.
- 2. Beneficiarul lucrării:** **Consiliul Judetean Cluj** , cu sediul în mun.Cluj Napoca str. 21 Decembrie 1989, jud. Cluj.
- 3. Executantul lucrării:** D&M TOPOGRAFIE SRL., aut. seria B nr. 634, cu sediul in Cluj-Napoca, Str. Taietura Turcului nr.47/8 reprezentata prin Cosmin Vesa – ing. topo, aut. seria MH nr. 065.
- 4. Obiectul lucrării:** Corpul de proprietate este situat în localitatea Cluj Napoca zona str. Taietura Turcului nr.47, jud. Cluj.
- 5. Scopul lucrării:** Documentatia topografică a fost executată la cererea beneficiarului pentru alipire.
- 6. Amplasamentul corpului de proprietate:** este amplasat în localitate Cluj Napoca str. Taietura Turcului nr.47, jud. Cluj. având ca vecini : la N- drum , la E- TETAROM , la S-Tetarom si la V- tetarom

SC D&M TOPOGRAFIE
Aut. B 634

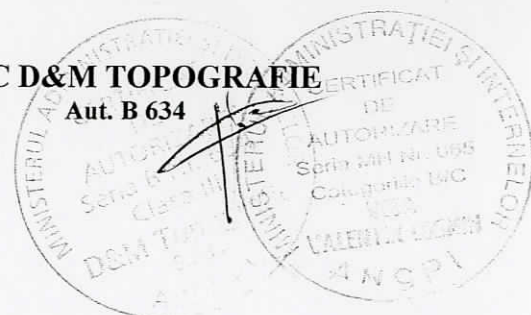



Cartea funciară cu nr. 1602
MEDEFINITIVA

Comuna/ Oraș/ Municipiu Chuy-N.

A. Partea I-a

Nr.crt.	Nr. cadastral	Descrierea imobilului	Suprafata în mp.	Observații <i>nr. top.</i>
1.	6897/1/16 6939/16 6940/16 6941/16 6942/16	 Teren	5200	21038/2/1/16 21043/2/1/16 21036/1/1/16 21037/2/1/16

222

B. Partea a II-a

Nr.crt.	Înscrieri privitoare la proprietate	Observații
	<p><u>Francis</u> <u>deu cf. 1126 N</u></p> <p>06.10.2005 31829</p> <p>act de alinaie de terenuri <u>peis c. de m</u></p> <p>act de denize <u>public</u> <u>Vi. Panta</u></p> <p>nr. <u>3231/07.10.2005</u> in a document <u>microsta</u></p> <p><u>comob.</u> <u>A41</u></p> <p>dreptul de prop. si <u>si</u></p> <p><u>proprietate privata in adiacenta</u></p> <p>in favoarea:</p> <ol style="list-style-type: none"> <u>JUDETUL CHEJ in adun.</u> <u>COMUNITATII JUDETEAN CHEJ peis</u> <u>SC TETAROM SA</u> 	

Nr.crt.

Cartea funciară cu nr. Comuna/ Oraș/ Municipiu

C. Partea a III- a

Nr.crt.	Înscrieri privitoare la sarcini	Observații
	<p data-bbox="820 499 1171 583">PENTRU CONFORMITATE</p> <p data-bbox="828 566 1099 765">12.10.2005</p> 	



Cartea funciară cu nr. 1601
NEDETIMITIVA

Comuna/ Oraș/ Municipiu Ciuj-Cl.

A. Partea I-a

Nr.crt.	Nr. cadastral	Descrierea imobilului	Suprafața În mp.	Observații (v. sep.)
1.	6897/1/15 6909/15 6910/15 6911/15 6912/15	Teren	7800	21038/2/1/15 ✓ 21043/2/1/15 ✓ 21036/1/1/15 ✓ 21037/2/1/15 ✓

B. Partea a II-a

Nr.crt.	Inscrieri privitoare la proprietate	Observatii
	<p align="center">- <u>Scursus din of. 11264</u> -</p> <p>Intrat la <u>06.10.2005</u> Nr. <u>31809</u></p> <p>in baza <u>act. de alinire de terenuri</u> <u>folia c. 54 in</u> <small>act. de alinire de terenuri public</small> <u>in baza</u> <u>act. de alinire de terenuri</u> <u>3234/06.10.2005 in a document. anevoie</u> <small>act. de alinire de terenuri</small> <u>de sub</u> <u>111</u> <small>sa incheieze dreptul de proprietate, cu titlul de</small> <u>proprietate primita in calitatea</u> <small>in favoarea</small></p> <ol style="list-style-type: none"> <u>JUDETUL CLUJ in adun.</u> <u>COMANDITULUI JUDETEAN CLUJ prin</u> <u>SC TETAROM SA.</u> 	

Cartea funciară cu nr. Comuna/ Oraș/ Municipiu

C. Partea a III- a

Nr.crt.	Înscrieri privitoare la sarcini	Observații
	<p data-bbox="740 526 1090 592">PENTRU CONFORMITATE</p> <p data-bbox="740 592 1013 783">12.10.2009</p> 	

TABEL DE MISCARE PARCELARA conform CF a imobilului situat in UAT Cluj-Napoca									
SITUATIA ACTUALA					SITUATIA VIITOARE DUPA ALIPIRE				
NR. CF	Nr.cad.	Nr.top	Descriere imobil	S (mp)	Proprietari	Nr.cad.	Descriere imobil	S (mp)	Proprietari
1602	6897/1/16, 6969/16... 6942/16		Teren	5200	Judetul Cluj, in administrarea Consiliului Judetean Cluj, prin SC Tetarom SA		Teren	13000	Judetul Cluj, in administrarea Consiliului Judetean Cluj, prin SC Tetarom SA conform HCJ nr.... din
1601	6897/1/15, 6939/15 ... 6942/15		Teren	7800	Judetul Cluj, in administrarea Consiliului Judetean Cluj, prin SC Tetarom SA				
Total									

5945: 13000

Intocmit
D&M TOPOGRAFIE
aut. B.634

Receptionat

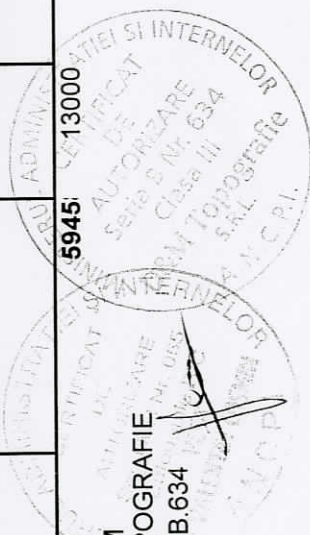

PLAN DE INCADRARE IN ZONA

Scara 1:5000

L-34-48-C-a-3-II

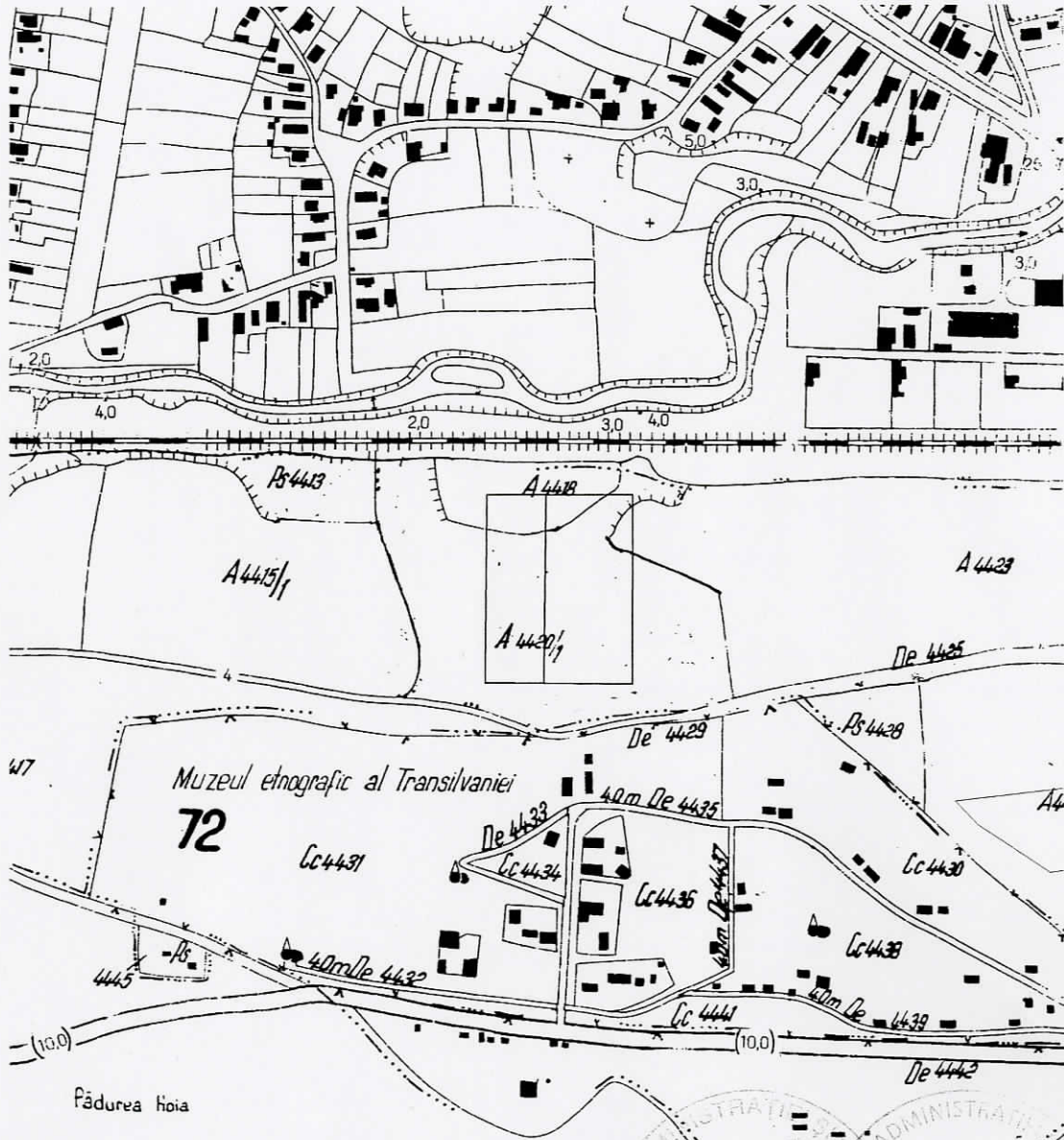

MINISTERUL ADMINISTRATIILOR SI TERENURILOR
CERTIFICAT DE AUTORIZARE
Seria MF Nr. 0
Categorie
Clasa III
Executant: D&M TOPOGRAFIE

**PLAN DE AMPLASAMENT SI DELIMITARE A IMOBILULUI
CU PROPUNEREA DE DEZLIPIRE**

Scara 1 : 1000

Nr.cadastral :	Suprafata mas.:	Adresa imobilului : Cluj-Napoca str.Taietura Turcului nr.47	
	13000mp.		
Cartea Funciara nr.		U.A.T.	Cluj-Napoca

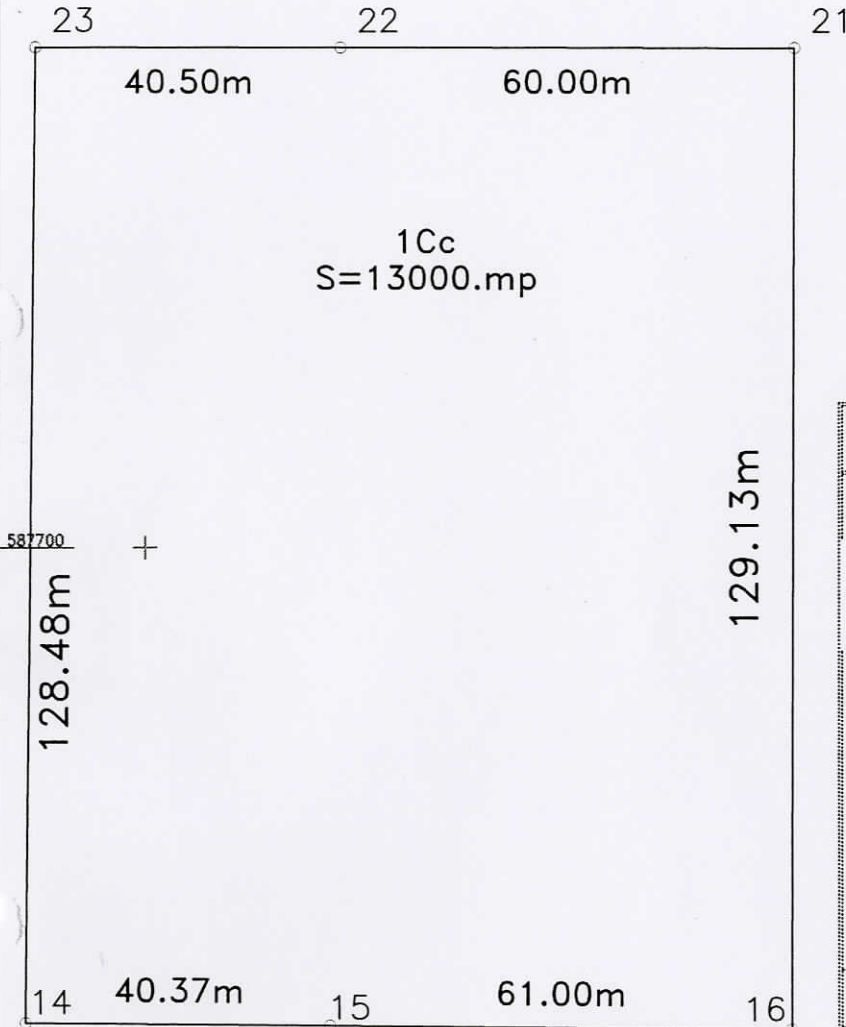

Inventar de coordonate-Stereografic 1970

	Coordonate pct.de contur	
	X [m]	Y [m]
23	587765.992	389785.448
22	587765.842	389825.950
21	587765.620	389885.950
16	587636.490	389885.560
15	587637.112	389824.565
14	587637.523	389784.202

Suprafata totala masurata=S(1Cc)=13000mp
Suprafata din act=13000mp



A. Date referitoare la teren

Nr. parcela	Categoria de folosinta	Suprafata	Valoarea de impozitare	Mentiuni
1	Cc	13000mp		fara gard
	Total	13000mp		

B. Date referitoare la constructii

Cod constr.	Suprafata construita la sol (mp)	Valoarea de impozitare (lei)	Mentiuni
Total			

**PLAN DE AMPLASAMENT SI DELIMITARE A IMOBILULUI
CU PROPUNEREA DE ALIPIRE**

Scara 1 : 1000

Nr.cadastral :	+	Suprafata mas.:	Adresa imobilului :	+
		13000mp.	Turcului nr.47	
Cartea Funciara nr.		U.A.T.	Cluj-napoca	

drum

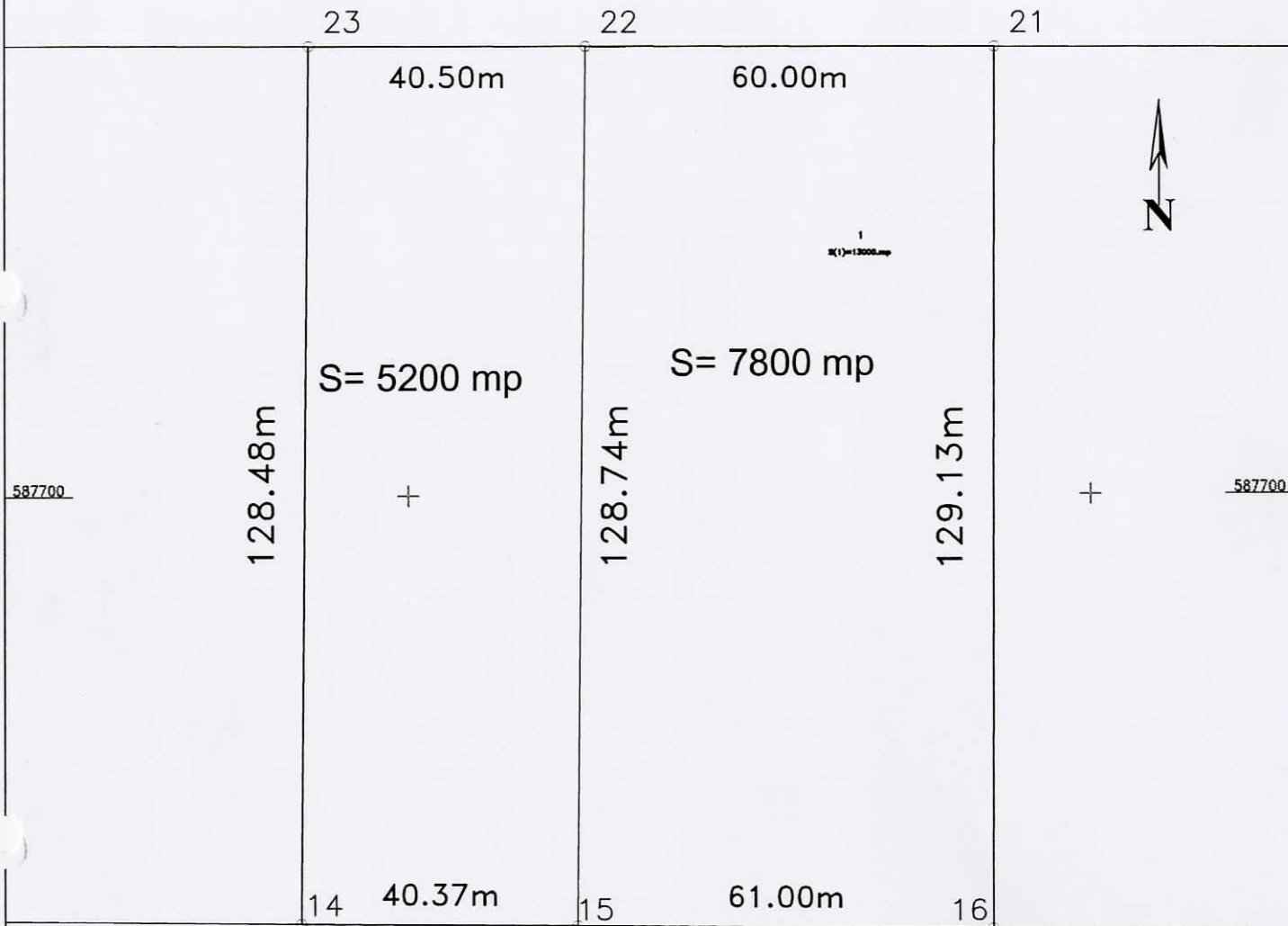

TABEL DE MISCARE PARCELARA PENTRU ALIPIRE IMOBIL

Situatia actuala (Inainte de alipire)				Situatia viitoare (dupa alipire)			
Nr. cad.	Suprafata (mp)	Cat. de folos.	Descrierea imobilului	Nr. cad.	Suprafata (mp)	Cat. de folos.	Descrierea imobilului
5897/1/15 - 5939/15 - 5942/15	7800	2	teren		13000	ICc	teren
5897/1/16 - 5939/16 - 5942/16	5200	3	teren				
Total				Total	13000		

Executant, DM TOPOGRAFIE

B. 634

Data decembrie 2008

Inspector :

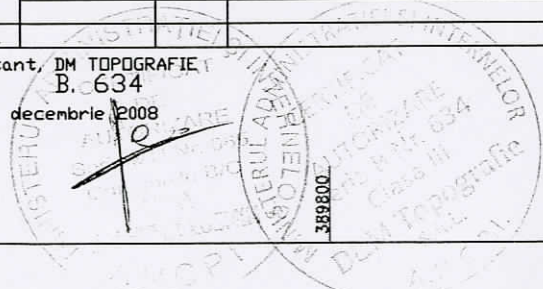

Executant masuratori topo: D&M TOPOGRAFIE, aut. Seria B nr. 634,
cu statia totala Pentax R325NX
cu precizia unghiulara 1.5mgon= de 5" si
la distanta de 1 - 5000 m cu precizia de ± (2mm+2ppm)

LEVEL Primary

OCCUPIEDSTATION 1	INSTRUMENT 1.295	NORTHING 527656.163	EASTING 389976.259	ELEVATION 349.970
REFSTATION 3	HA 373.1393	VA 92.4290	TARGET 0.000	DESCRIPTION TTurcului NORTHING 527271.010
EASTING 390437.360				
SIDESHOT 4	HA	203.9962	VA 102.8753	SLOPE 122.940 TARGET 1.700
SIDESHOT 5	HA	204.7659	VA 102.9339	SLOPE 124.260 TARGET 1.700
SIDESHOT 6	HA	206.9105	VA 102.9349	SLOPE 130.203 TARGET 1.700
SIDESHOT 7	HA	206.9097	VA 102.9019	SLOPE 130.218 TARGET 1.700
SIDESHOT 8	HA	214.5633	VA 102.9666	SLOPE 126.273 TARGET 1.700
SIDESHOT 9	HA	223.5654	VA 103.1287	SLOPE 122.825 TARGET 1.700
SIDESHOT 10	HA	226.3890	VA 103.1095	SLOPE 122.539 TARGET 1.700
SIDESHOT 11	HA	223.0440	VA 103.1988	SLOPE 115.904 TARGET 1.700
SIDESHOT 12	HA	223.0303	VA 103.1542	SLOPE 114.035 TARGET 1.700
SIDESHOT 13	HA	224.5572	VA 103.2128	SLOPE 115.388 TARGET 1.700
SIDESHOT 14	HA	226.1940	VA 103.2129	SLOPE 113.771 TARGET 1.700
SIDESHOT 15	HA	227.7258	VA 103.3158	SLOPE 110.421 TARGET 1.700
SIDESHOT 16	HA	227.0583	VA 103.2394	SLOPE 108.327 TARGET 1.700
SIDESHOT 17	HA	228.7476	VA 103.3134	SLOPE 110.717 TARGET 1.700
SIDESHOT 18	HA	232.3843	VA 103.0816	SLOPE 123.001 TARGET 1.700
SIDESHOT 19	HA	238.4983	VA 103.0823	SLOPE 123.652 TARGET 1.700
SIDESHOT 20	HA	245.8061	VA 103.0053	SLOPE 126.640 TARGET 1.700
SIDESHOT 21	HA	245.7543	VA 103.0934	SLOPE 119.475 TARGET 1.700
SIDESHOT 22	HA	245.7757	VA 103.0413	SLOPE 117.575 TARGET 1.700
SIDESHOT 23	HA	241.8952	VA 103.1576	SLOPE 117.553 TARGET 1.700
SIDESHOT 24	HA	241.6438	VA 103.1193	SLOPE 115.544 TARGET 1.700
SIDESHOT 25	HA	239.2522	VA 102.9240	SLOPE 115.042 TARGET 2.200
SIDESHOT 26	HA	239.5174	VA 102.8926	SLOPE 113.458 TARGET 2.200
SIDESHOT 27	HA	236.1736	VA 103.2954	SLOPE 110.148 TARGET 1.700
SIDESHOT 28	HA	235.9483	VA 103.2298	SLOPE 106.907 TARGET 1.700
SIDESHOT 29	HA	234.1950	VA 103.3069	SLOPE 104.697 TARGET 1.700
SIDESHOT 30	HA	228.5659	VA 103.4104	SLOPE 105.748 TARGET 1.700
SIDESHOT 31	HA	233.3283	VA 103.3286	SLOPE 99.589 TARGET 1.700
SIDESHOT 32	HA	234.2374	VA 103.2432	SLOPE 98.743 TARGET 1.700
SIDESHOT 33	HA	234.5559	VA 103.2069	SLOPE 90.378 TARGET 1.700
SIDESHOT 34	HA	234.6681	VA 103.2634	SLOPE 72.271 TARGET 1.700
SIDESHOT 35	HA	228.3887	VA 103.4085	SLOPE 71.364 TARGET 1.700
SIDESHOT 36	HA	237.9690	VA 103.0050	SLOPE 56.341 TARGET 1.700
SIDESHOT 37	HA	238.8799	VA 102.9298	SLOPE 40.677 TARGET 1.700
SIDESHOT 38	HA	227.8217	VA 103.2307	SLOPE 38.894 TARGET 1.700
SIDESHOT 39	HA	227.9452	VA 103.0359	SLOPE 27.186 TARGET 1.700
SIDESHOT 40	HA	243.8085	VA 102.5705	SLOPE 28.391 TARGET 1.700
SIDESHOT 41	HA	247.7172	VA 102.2571	SLOPE 28.216 TARGET 1.700
SIDESHOT 42	HA	251.7069	VA 98.7444	SLOPE 24.618 TARGET 2.900
SIDESHOT 43	HA	251.2743	VA 98.5583	SLOPE 21.648 TARGET 2.900
SIDESHOT 44	HA	235.6800	VA 102.6488	SLOPE 15.377 TARGET 1.700
SIDESHOT 45	HA	196.8654	VA 103.4073	SLOPE 12.104 TARGET 1.700
SIDESHOT 46	HA	182.2892	VA 103.9024	SLOPE 14.269 TARGET 1.700
SIDESHOT 47	HA	157.3149	VA 103.6395	SLOPE 10.482 TARGET 1.700
SIDESHOT 48	HA	171.1259	VA 102.9472	SLOPE 7.391 TARGET 1.700
SIDESHOT 49	HA	178.7186	VA 102.9442	SLOPE 7.246 TARGET 1.700
SIDESHOT 50	HA	314.6858	VA 98.8196	SLOPE 6.760 TARGET 1.700
SIDESHOT 51	HA	309.7878	VA 98.2397	SLOPE 13.614 TARGET 1.700
SIDESHOT 52	HA	311.6025	VA 97.8943	SLOPE 15.301 TARGET 1.700
SIDESHOT 53	HA	340.6126	VA 96.6311	SLOPE 19.970 TARGET 1.700
SIDESHOT 54	HA	345.1486	VA 96.9650	SLOPE 19.318 TARGET 1.700
SIDESHOT 55	HA	345.8055	VA 96.6304	SLOPE 23.806 TARGET 1.700
SIDESHOT 56	HA	351.0895	VA 96.9289	SLOPE 26.097 TARGET 1.700
SIDESHOT 57	HA	347.8908	VA 97.1669	SLOPE 39.329 TARGET 1.700
SIDESHOT 58	HA	345.0394	VA 96.9900	SLOPE 39.725 TARGET 1.700
SIDESHOT 59	HA	336.5151	VA 97.7835	SLOPE 58.957 TARGET 1.700
SIDESHOT 60	HA	338.0342	VA 97.8858	SLOPE 59.421 TARGET 1.700
SIDESHOT 61	HA	340.2184	VA 97.9178	SLOPE 59.491 TARGET 1.700
SIDESHOT 62	HA	335.7121	VA 98.4662	SLOPE 81.730 TARGET 1.700
SIDESHOT 63	HA	330.2188	VA 98.4585	SLOPE 93.201 TARGET 1.700
SIDESHOT 64	HA	331.0560	VA 98.6083	SLOPE 95.225 TARGET 1.700
SIDESHOT 65	HA	329.0543	VA 98.8260	SLOPE 116.228 TARGET 1.700
SIDESHOT 66	HA	329.6240	VA 98.8589	SLOPE 117.739 TARGET 1.700
SIDESHOT 67	HA	336.8491	VA 98.8101	SLOPE 114.469 TARGET 1.700
SIDESHOT 68	HA	334.2131	VA 98.8495	SLOPE 112.358 TARGET 1.700
SIDESHOT 69	HA	333.9749	VA 98.8666	SLOPE 111.506 TARGET 1.700
SIDESHOT 70	HA	333.7623	VA 98.8643	SLOPE 109.643 TARGET 1.700
SIDESHOT 71	HA	336.1266	VA 98.7095	SLOPE 100.689 TARGET 1.700
SIDESHOT 72	HA	335.6277	VA 98.6902	SLOPE 100.523 TARGET 1.700
SIDESHOT 73	HA	334.5617	VA 98.7886	SLOPE 103.100 TARGET 1.700

SIDESHOT 74	HA	336.1506	VA	98.6396	SLOPE	95.699	TARGET	1.700
SIDESHOT 75	HA	338.5674	VA	98.5143	SLOPE	87.821	TARGET	1.700
SIDESHOT 76	HA	336.1167	VA	98.5442	SLOPE	87.331	TARGET	1.700
SIDESHOT 77	HA	341.5857	VA	98.2264	SLOPE	83.863	TARGET	1.700
SIDESHOT 78	HA	339.4750	VA	98.3997	SLOPE	82.000	TARGET	1.700
SIDESHOT 79	HA	339.7166	VA	98.4764	SLOPE	81.857	TARGET	1.700
SIDESHOT 80	HA	343.1568	VA	98.2779	SLOPE	75.129	TARGET	1.700
SIDESHOT 81	HA	344.7776	VA	98.1137	SLOPE	74.937	TARGET	1.700
SIDESHOT 82	HA	346.5644	VA	97.8008	SLOPE	66.861	TARGET	1.700
SIDESHOT 83	HA	344.7557	VA	97.9629	SLOPE	66.724	TARGET	1.700
SIDESHOT 84	HA	343.8008	VA	98.0509	SLOPE	64.514	TARGET	1.700
SIDESHOT 85	HA	350.4533	VA	97.5814	SLOPE	55.828	TARGET	1.700
SIDESHOT 86	HA	352.9382	VA	97.4595	SLOPE	52.094	TARGET	1.700
SIDESHOT 87	HA	355.1592	VA	97.4316	SLOPE	53.185	TARGET	1.700
SIDESHOT 88	HA	348.9312	VA	97.5678	SLOPE	63.401	TARGET	1.700
SIDESHOT 89	HA	355.8256	VA	97.0614	SLOPE	65.561	TARGET	1.700
SIDESHOT 90	HA	356.4763	VA	97.0607	SLOPE	71.180	TARGET	1.700
SIDESHOT 91	HA	357.0737	VA	96.9645	SLOPE	72.645	TARGET	1.700
SIDESHOT 92	HA	363.9613	VA	96.4533	SLOPE	77.326	TARGET	1.700
SIDESHOT 93	HA	365.0359	VA	96.4448	SLOPE	76.315	TARGET	1.700
SIDESHOT 94	HA	364.7218	VA	96.5283	SLOPE	68.851	TARGET	1.700
SIDESHOT 95	HA	366.8520	VA	96.4296	SLOPE	68.861	TARGET	1.700
SIDESHOT 96	HA	368.6473	VA	96.3294	SLOPE	66.490	TARGET	1.700
SIDESHOT 97	HA	369.3710	VA	96.3613	SLOPE	84.386	TARGET	1.700
SIDESHOT 98	HA	368.6705	VA	96.2665	SLOPE	86.897	TARGET	1.700
SIDESHOT 99	HA	368.8012	VA	96.2652	SLOPE	91.489	TARGET	1.700
SIDESHOT 100	HA	369.3189	VA	96.2641	SLOPE	92.416	TARGET	1.700
SIDESHOT 101	HA	370.4317	VA	96.3395	SLOPE	93.206	TARGET	1.700
SIDESHOT 102	HA	371.0856	VA	96.3969	SLOPE	133.247	TARGET	1.700
SIDESHOT 103	HA	371.8239	VA	96.0583	SLOPE	134.596	TARGET	1.700
SIDESHOT 104	HA	371.9176	VA	96.5380	SLOPE	169.550	TARGET	1.700
SIDESHOT 105	HA	372.5042	VA	96.5227	SLOPE	172.814	TARGET	1.700
SIDESHOT 106	HA	372.0264	VA	96.4948	SLOPE	176.203	TARGET	1.700
SIDESHOT 107	HA	371.8362	VA	96.4508	SLOPE	179.452	TARGET	1.700
SIDESHOT 108	HA	371.2633	VA	96.4706	SLOPE	178.298	TARGET	1.700
SIDESHOT 109	HA	369.6991	VA	96.4198	SLOPE	179.761	TARGET	1.700
SIDESHOT 110	HA	367.7401	VA	96.3649	SLOPE	180.550	TARGET	1.700
SIDESHOT 111	HA	366.5200	VA	96.3516	SLOPE	180.933	TARGET	1.700
SIDESHOT 112	HA	359.9589	VA	94.9371	SLOPE	224.655	TARGET	5.000
SIDESHOT 113	HA	358.1057	VA	94.9187	SLOPE	218.753	TARGET	5.000
SIDESHOT 114	HA	354.8127	VA	94.8068	SLOPE	254.992	TARGET	1.700
SIDESHOT 115	HA	367.7784	VA	96.6999	SLOPE	247.121	TARGET	1.700
SIDESHOT 116	HA	366.6512	VA	96.7806	SLOPE	242.263	TARGET	1.700
SIDESHOT 117	HA	366.8293	VA	96.6802	SLOPE	236.548	TARGET	1.700
SIDESHOT 118	HA	365.9746	VA	96.6313	SLOPE	237.099	TARGET	1.700
SIDESHOT 119	HA	369.3481	VA	96.6472	SLOPE	237.012	TARGET	1.700
SIDESHOT 120	HA	364.6184	VA	96.8171	SLOPE	233.770	TARGET	1.700
SIDESHOT 121	HA	363.7398	VA	96.7595	SLOPE	231.221	TARGET	1.700
SIDESHOT 122	HA	361.0144	VA	94.7804	SLOPE	223.035	TARGET	1.700
SIDESHOT 123	HA	360.6703	VA	94.7284	SLOPE	219.133	TARGET	1.700
SIDESHOT 124	HA	360.0385	VA	94.7319	SLOPE	219.244	TARGET	1.700
SIDESHOT 125	HA	363.2977	VA	96.6711	SLOPE	211.959	TARGET	1.700
SIDESHOT 126	HA	363.2974	VA	96.6712	SLOPE	212.735	TARGET	1.700
SIDESHOT 127	HA	363.3854	VA	96.6772	SLOPE	213.365	TARGET	1.700
SIDESHOT 128	HA	364.8308	VA	96.7038	SLOPE	217.346	TARGET	1.700
SIDESHOT 129	HA	365.1161	VA	96.6930	SLOPE	217.525	TARGET	1.700
SIDESHOT 130	HA	365.3190	VA	96.6749	SLOPE	216.654	TARGET	1.700
SIDESHOT 131	HA	365.4010	VA	96.5810	SLOPE	206.050	TARGET	1.700
SIDESHOT 132	HA	365.2639	VA	96.5671	SLOPE	205.054	TARGET	1.700
SIDESHOT 133	HA	364.9831	VA	96.5753	SLOPE	205.113	TARGET	1.700
SIDESHOT 134	HA	370.4138	VA	96.4917	SLOPE	200.537	TARGET	1.700
SIDESHOT 135	HA	370.8078	VA	96.5289	SLOPE	195.524	TARGET	1.700
SIDESHOT 136	HA	371.3308	VA	96.2607	SLOPE	193.790	TARGET	1.700
SIDESHOT 137	HA	369.5686	VA	96.4198	SLOPE	193.532	TARGET	1.700
SIDESHOT 138	HA	370.8693	VA	96.3554	SLOPE	190.757	TARGET	1.700
SIDESHOT 139	HA	372.2919	VA	96.2627	SLOPE	190.205	TARGET	1.700
SIDESHOT 140	HA	372.7959	VA	96.2071	SLOPE	195.231	TARGET	1.700
SIDESHOT 141	HA	372.4015	VA	96.0455	SLOPE	202.405	TARGET	1.700
SIDESHOT 142	HA	373.0559	VA	94.8642	SLOPE	224.033	TARGET	1.700
SIDESHOT 143	HA	372.7403	VA	94.7167	SLOPE	234.953	TARGET	1.700
SIDESHOT 144	HA	372.9941	VA	94.4407	SLOPE	267.829	TARGET	1.700
SIDESHOT 145	HA	373.3843	VA	94.4713	SLOPE	270.026	TARGET	1.700
SIDESHOT 146	HA	373.2360	VA	94.2563	SLOPE	300.547	TARGET	1.700
SIDESHOT 147	HA	373.5510	VA	94.2734	SLOPE	302.381	TARGET	1.700
SIDESHOT 148	HA	373.4080	VA	94.2506	SLOPE	335.218	TARGET	1.700
SIDESHOT 149	HA	373.6694	VA	94.2975	SLOPE	337.067	TARGET	1.700
SIDESHOT 150	HA	373.7716	VA	94.4810	SLOPE	359.507	TARGET	1.700
SIDESHOT 151	HA	373.5194	VA	94.4890	SLOPE	361.151	TARGET	1.700
SIDESHOT 152	HA	373.4654	VA	94.5163	SLOPE	362.521	TARGET	1.700
SIDESHOT 153	HA	370.9311	VA	94.1800	SLOPE	355.320	TARGET	1.700
SIDESHOT 154	HA	370.7903	VA	94.2622	SLOPE	358.993	TARGET	1.700
SIDESHOT 155	HA	373.1718	VA	94.4023	SLOPE	365.544	TARGET	1.700
SIDESHOT 156	HA	373.6179	VA	94.3804	SLOPE	364.602	TARGET	1.700
SIDESHOT 157	HA	373.7606	VA	94.5404	SLOPE	362.539	TARGET	1.700
SIDESHOT 158	HA	375.4334	VA	94.6126	SLOPE	375.773	TARGET	1.700
SIDESHOT 159	HA	375.1043	VA	94.5670	SLOPE	373.443	TARGET	1.700
SIDESHOT 160	HA	375.0160	VA	94.5418	SLOPE	368.435	TARGET	1.700
SIDESHOT 161	HA	375.0220	VA	94.5108	SLOPE	360.307	TARGET	1.700
SIDESHOT 162	HA	375.2148	VA	94.5142	SLOPE	359.029	TARGET	1.700

SIDESHOT 163	HA	375.4589	VA	94.5139	SLOPE	359.152	TARGET	1.700
SIDESHOT 164	HA	376.1454	VA	93.8756	SLOPE	360.451	TARGET	1.700
SIDESHOT 165	HA	375.4073	VA	94.3768	SLOPE	315.425	TARGET	1.700
SIDESHOT 166	HA	375.2620	VA	94.2779	SLOPE	314.605	TARGET	1.700
SIDESHOT 167	HA	375.6208	VA	94.2949	SLOPE	308.225	TARGET	1.700
SIDESHOT 168	HA	376.9475	VA	94.5150	SLOPE	272.797	TARGET	1.700
SIDESHOT 169	HA	375.7036	VA	94.5086	SLOPE	269.912	TARGET	1.700
SIDESHOT 170	HA	375.3142	VA	94.5191	SLOPE	268.359	TARGET	1.700
SIDESHOT 171	HA	377.8536	VA	94.9911	SLOPE	216.538	TARGET	1.700
SIDESHOT 172	HA	375.9121	VA	95.0353	SLOPE	212.636	TARGET	1.700
SIDESHOT 173	HA	375.4306	VA	95.0496	SLOPE	210.546	TARGET	1.700
SIDESHOT 174	HA	378.5981	VA	95.2938	SLOPE	170.869	TARGET	1.700
SIDESHOT 175	HA	376.8587	VA	95.3987	SLOPE	175.155	TARGET	1.700
SIDESHOT 176	HA	376.6549	VA	95.6230	SLOPE	166.762	TARGET	1.700
SIDESHOT 177	HA	376.2286	VA	95.7339	SLOPE	163.387	TARGET	1.700
SIDESHOT 178	HA	375.5753	VA	95.7423	SLOPE	162.195	TARGET	1.700
SIDESHOT 179	HA	375.6005	VA	96.2350	SLOPE	122.562	TARGET	1.700
SIDESHOT 180	HA	376.6633	VA	96.2596	SLOPE	122.210	TARGET	1.700
SIDESHOT 181	HA	377.7211	VA	95.8979	SLOPE	121.302	TARGET	1.700
SIDESHOT 182	HA	381.0880	VA	95.4265	SLOPE	115.975	TARGET	1.700
SIDESHOT 183	HA	383.4417	VA	94.7371	SLOPE	70.658	TARGET	1.700
SIDESHOT 184	HA	379.3914	VA	95.1939	SLOPE	69.948	TARGET	1.700
SIDESHOT 185	HA	378.0495	VA	96.4489	SLOPE	68.889	TARGET	1.700
SIDESHOT 186	HA	376.5600	VA	96.4016	SLOPE	67.424	TARGET	1.700
SIDESHOT 187	HA	366.2305	VA	96.3576	SLOPE	58.370	TARGET	1.700
SIDESHOT 188	HA	365.4212	VA	96.4271	SLOPE	43.956	TARGET	1.700
SIDESHOT 189	HA	362.4644	VA	96.6086	SLOPE	41.586	TARGET	1.700
SIDESHOT 190	HA	358.3052	VA	96.9671	SLOPE	42.041	TARGET	1.700
SIDESHOT 191	HA	364.6221	VA	96.5991	SLOPE	33.022	TARGET	1.700
SIDESHOT 192	HA	376.0742	VA	96.4252	SLOPE	40.695	TARGET	1.700
SIDESHOT 193	HA	377.6643	VA	96.4735	SLOPE	40.693	TARGET	1.700
SIDESHOT 194	HA	380.3255	VA	96.4875	SLOPE	41.265	TARGET	1.700
SIDESHOT 195	HA	381.1597	VA	96.0987	SLOPE	41.342	TARGET	1.700
SIDESHOT 196	HA	379.9497	VA	96.4614	SLOPE	42.226	TARGET	1.700
SIDESHOT 197	HA	389.8869	VA	93.8442	SLOPE	47.256	TARGET	1.700
SIDESHOT 198	HA	12.2341	VA	91.0646	SLOPE	33.896	TARGET	1.700
SIDESHOT 199	HA	38.6627	VA	91.4171	SLOPE	35.947	TARGET	1.700
SIDESHOT 200	HA	83.0075	VA	94.0160	SLOPE	66.872	TARGET	1.700
SIDESHOT 201	HA	85.6735	VA	95.1209	SLOPE	51.898	TARGET	1.700
SIDESHOT 202	HA	85.5998	VA	95.0214	SLOPE	48.949	TARGET	1.700
SIDESHOT 203	HA	78.4266	VA	94.6216	SLOPE	42.551	TARGET	1.700
SIDESHOT 204	HA	79.7788	VA	94.3887	SLOPE	41.527	TARGET	1.700
SIDESHOT 205	HA	47.2556	VA	96.6543	SLOPE	31.666	TARGET	1.700
SIDESHOT 206	HA	49.6560	VA	96.7342	SLOPE	29.236	TARGET	1.700
SIDESHOT 207	HA	40.9565	VA	96.9263	SLOPE	28.947	TARGET	1.700
SIDESHOT 208	HA	48.7265	VA	98.3327	SLOPE	21.623	TARGET	1.700
SIDESHOT 209	HA	50.1412	VA	98.3440	SLOPE	20.135	TARGET	1.700
SIDESHOT 210	HA	3.1496	VA	95.9251	SLOPE	21.517	TARGET	1.700
SIDESHOT 211	HA	393.1054	VA	96.6472	SLOPE	26.941	TARGET	1.700
SIDESHOT 212	HA	390.3454	VA	96.5720	SLOPE	25.755	TARGET	1.700
SIDESHOT 213	HA	383.5820	VA	96.1222	SLOPE	36.559	TARGET	1.700
SIDESHOT 214	HA	382.9528	VA	96.5713	SLOPE	36.359	TARGET	1.700
SIDESHOT 215	HA	380.0694	VA	96.5307	SLOPE	35.861	TARGET	1.700
SIDESHOT 216	HA	376.9373	VA	96.3581	SLOPE	35.370	TARGET	1.700
SIDESHOT 217	HA	375.7845	VA	96.3859	SLOPE	33.358	TARGET	1.700
SIDESHOT 218	HA	371.0405	VA	96.5801	SLOPE	17.738	TARGET	1.700
SIDESHOT 219	HA	314.5098	VA	96.6063	SLOPE	6.705	TARGET	1.700
SIDESHOT 220	HA	161.7437	VA	104.3707	SLOPE	7.429	TARGET	1.700
SIDESHOT 221	HA	155.7070	VA	103.5441	SLOPE	10.345	TARGET	1.700

OCCUPIEDSTATION 1 INSTRUMENT 1.425 TARGET 1.700 NORTHING 587749.394 EASTING 399599.708 ELEVATION 354.850

REFSTATION 2	HA	117.4406	DESCRIPTION	Steluta	NORTHING	590443.220	EASTING	391928.280
REFSTATION 3	HA	199.9997						
REFSTATION 4	HA	205.2687						
SIDESHOT 5	HA	13.7034	VA	113.2362	SLOPE	26.180	TARGET	1.700
SIDESHOT 6	HA	0.1537	VA	110.7766	SLOPE	31.770		
SIDESHOT 7	HA	396.9494	VA	104.9586	SLOPE	73.197		
SIDESHOT 8	HA	390.6260	VA	103.8494	SLOPE	64.468	TARGET	3.150
SIDESHOT 9	HA	387.4966	VA	104.9372	SLOPE	69.634	TARGET	1.700
SIDESHOT 10	HA	387.6154	VA	105.0378	SLOPE	67.566		
SIDESHOT 11	HA	387.1219	VA	105.3308	SLOPE	63.309		
SIDESHOT 12	HA	387.8176	VA	105.8206	SLOPE	63.595		
SIDESHOT 13	HA	390.7608	VA	103.6014	SLOPE	104.222		
SIDESHOT 14	HA	390.1851	VA	103.6254	SLOPE	107.362		
SIDESHOT 15	HA	388.4960	VA	103.3328	SLOPE	105.909		
SIDESHOT 16	HA	384.3311	VA	101.8627	SLOPE	104.943	TARGET	4.000
SIDESHOT 17	HA	383.9809	VA	101.9047	SLOPE	98.283	TARGET	4.000
SIDESHOT 18	HA	384.9164	VA	101.3913	SLOPE	91.932	TARGET	5.000
SIDESHOT 19	HA	382.3783	VA	101.6898	SLOPE	93.193	TARGET	5.000
SIDESHOT 20	HA	381.0003	VA	103.5636	SLOPE	93.144	TARGET	1.700
SIDESHOT 21	HA	380.1596	VA	103.2878	SLOPE	94.131		
SIDESHOT 22	HA	379.6397	VA	103.1860	SLOPE	100.037		
SIDESHOT 23	HA	377.4022	VA	102.9491	SLOPE	102.829		
SIDESHOT 24	HA	380.1344	VA	103.1185	SLOPE	107.356		
SIDESHOT 25	HA	380.7166	VA	103.3490	SLOPE	106.486		
SIDESHOT 26	HA	381.1165	VA	103.0483	SLOPE	108.884		
SIDESHOT 27	HA	380.3076	VA	103.0660	SLOPE	107.562		
SIDESHOT 28	HA	380.1388	VA	103.0470	SLOPE	108.889		
SIDESHOT 29	HA	363.2402	VA	102.2191	SLOPE	107.921		

SIDESHOT 30	HA	363.8585	VA	102.4137	SLOPE	108.253	
SIDESHOT 31	HA	363.4017	VA	102.1982	SLOPE	108.755	
SIDESHOT 32	HA	346.1683	VA	101.2275	SLOPE	112.639	
SIDESHOT 33	HA	333.2304	VA	100.3433	SLOPE	131.376	
SIDESHOT 34	HA	332.8655	VA	100.2945	SLOPE	132.117	
SIDESHOT 35	HA	332.8287	VA	100.1940	SLOPE	133.325	
SIDESHOT 36	HA	327.9941	VA	97.8956	SLOPE	143.744	
SIDESHOT 37	HA	322.6491	VA	97.9353	SLOPE	147.889	
SIDESHOT 38	HA	331.7368	VA	97.8888	SLOPE	171.714	
SIDESHOT 39	HA	334.9784	VA	98.0011	SLOPE	166.454	
SIDESHOT 40	HA	340.8197	VA	98.0488	SLOPE	197.113	
SIDESHOT 41	HA	338.7719	VA	97.9047	SLOPE	200.596	
SIDESHOT 42	HA	343.2001	VA	97.9236	SLOPE	228.444	
SIDESHOT 43	HA	344.7455	VA	98.0501	SLOPE	226.162	
SIDESHOT 44	HA	347.2258	VA	98.2008	SLOPE	243.802	
SIDESHOT 45	HA	346.9282	VA	98.0823	SLOPE	245.767	
SIDESHOT 46	HA	347.3500	VA	98.0696	SLOPE	253.670	
SIDESHOT 47	HA	349.6117	VA	98.1161	SLOPE	272.023	
SIDESHOT 48	HA	350.8111	VA	98.2871	SLOPE	270.270	
SIDESHOT 49	HA	351.6380	VA	98.3175	SLOPE	276.278	
SIDESHOT 50	HA	350.9231	VA	98.1533	SLOPE	282.837	
SIDESHOT 51	HA	352.2656	VA	98.2342	SLOPE	294.632	
SIDESHOT 52	HA	354.9820	VA	98.4783	SLOPE	285.974	
SIDESHOT 53	HA	357.0603	VA	98.6850	SLOPE	284.586	
SIDESHOT 54	HA	359.6168	VA	98.9036	SLOPE	289.606	
SIDESHOT 55	HA	363.5562	VA	99.4510	SLOPE	289.920	
SIDESHOT 56	HA	363.3147	VA	99.5721	SLOPE	274.913	
SIDESHOT 57	HA	370.5240	VA	100.6236	SLOPE	268.677	
SIDESHOT 58	HA	370.7046	VA	100.6396	SLOPE	266.226	
SIDESHOT 59	HA	370.8612	VA	100.6197	SLOPE	291.952	
SIDESHOT 60	HA	373.9477	VA	101.1355	SLOPE	283.915	
SIDESHOT 61	HA	379.5639	VA	101.1012	SLOPE	284.785	TARGET 4.000
SIDESHOT 62	HA	378.4460	VA	101.0642	SLOPE	268.289	TARGET 1.700
SIDESHOT 63	HA	376.8518	VA	101.0311	SLOPE	267.628	
SIDESHOT 64	HA	376.3787	VA	101.0025	SLOPE	267.885	
SIDESHOT 65	HA	376.3495	VA	100.9967	SLOPE	263.399	
SIDESHOT 66	HA	376.1000	VA	100.9762	SLOPE	262.700	
SIDESHOT 67	HA	375.6636	VA	101.1683	SLOPE	259.476	
SIDESHOT 68	HA	375.5170	VA	101.1051	SLOPE	266.083	
SIDESHOT 69	HA	375.3957	VA	101.0488	SLOPE	265.490	
SIDESHOT 70	HA	375.6663	VA	101.0947	SLOPE	266.882	
SIDESHOT 71	HA	373.3068	VA	100.9837	SLOPE	251.873	
SIDESHOT 72	HA	372.0871	VA	101.0145	SLOPE	250.759	
SIDESHOT 73	HA	372.0740	VA	101.0341	SLOPE	243.859	
SIDESHOT 74	HA	372.3385	VA	101.0247	SLOPE	241.967	
SIDESHOT 75	HA	367.8636	VA	100.7899	SLOPE	243.392	
SIDESHOT 76	HA	367.5449	VA	100.6477	SLOPE	264.614	
SIDESHOT 77	HA	366.1039	VA	100.5313	SLOPE	266.196	
SIDESHOT 78	HA	361.2216	VA	100.3567	SLOPE	267.473	
SIDESHOT 79	HA	361.2273	VA	100.2991	SLOPE	266.631	
SIDESHOT 80	HA	361.5386	VA	100.4306	SLOPE	251.027	
SIDESHOT 81	HA	357.2056	VA	100.1939	SLOPE	251.284	
SIDESHOT 82	HA	356.5873	VA	100.0900	SLOPE	263.965	
SIDESHOT 83	HA	354.9900	VA	100.0700	SLOPE	258.657	
SIDESHOT 84	HA	354.6364	VA	100.1418	SLOPE	258.083	
SIDESHOT 85	HA	352.2701	VA	100.0275	SLOPE	245.953	
SIDESHOT 86	HA	351.8479	VA	100.1132	SLOPE	241.660	
SIDESHOT 87	HA	351.8296	VA	100.0245	SLOPE	240.252	
SIDESHOT 88	HA	356.0869	VA	100.2149	SLOPE	233.279	
SIDESHOT 89	HA	354.4166	VA	100.2479	SLOPE	211.773	
SIDESHOT 90	HA	349.8740	VA	100.1027	SLOPE	225.921	
SIDESHOT 91	HA	349.4567	VA	100.0314	SLOPE	223.007	
SIDESHOT 92	HA	349.7139	VA	100.0233	SLOPE	221.714	
SIDESHOT 93	HA	344.6510	VA	100.1260	SLOPE	178.594	
SIDESHOT 94	HA	345.0987	VA	100.1195	SLOPE	177.925	
SIDESHOT 95	HA	343.4036	VA	100.2286	SLOPE	167.982	
SIDESHOT 96	HA	348.3125	VA	100.3362	SLOPE	161.747	
SIDESHOT 97	HA	342.8318	VA	100.5381	SLOPE	132.436	
SIDESHOT 98	HA	357.7251	VA	101.5629	SLOPE	124.582	
SIDESHOT 99	HA	369.1545	VA	102.1180	SLOPE	123.465	
SIDESHOT 100	HA	370.2740	VA	101.6423	SLOPE	160.760	
SIDESHOT 101	HA	361.6980	VA	101.1634	SLOPE	162.447	
SIDESHOT 102	HA	363.5647	VA	100.9212	SLOPE	191.146	
SIDESHOT 103	HA	370.4289	VA	101.2864	SLOPE	191.610	
SIDESHOT 104	HA	370.9084	VA	101.0954	SLOPE	221.603	
SIDESHOT 105	HA	365.2751	VA	100.7725	SLOPE	224.180	
SIDESHOT 106	HA	375.0392	VA	101.2777	SLOPE	230.888	
SIDESHOT 107	HA	375.9614	VA	101.3654	SLOPE	236.243	
SIDESHOT 108	HA	376.3735	VA	101.1768	SLOPE	236.001	
SIDESHOT 109	HA	376.6911	VA	101.1957	SLOPE	236.472	
SIDESHOT 110	HA	379.1780	VA	101.1770	SLOPE	247.496	
SIDESHOT 111	HA	379.4536	VA	101.3319	SLOPE	229.263	
SIDESHOT 112	HA	376.3878	VA	101.3154	SLOPE	231.300	
SIDESHOT 113	HA	376.3321	VA	101.3073	SLOPE	228.053	
SIDESHOT 114	HA	375.6762	VA	101.3168	SLOPE	227.405	
SIDESHOT 115	HA	376.4219	VA	101.6132	SLOPE	210.467	
SIDESHOT 116	HA	375.6960	VA	101.0877	SLOPE	206.519	TARGET 2.900
SIDESHOT 117	HA	376.2878	VA	101.5408	SLOPE	201.033	TARGET 1.700
SIDESHOT 118	HA	376.8250	VA	101.5624	SLOPE	200.898	

SIDESHOT 119	HA	377.9368	VA	101.6143	SLOPE	191.599	
SIDESHOT 120	HA	378.6322	VA	101.6969	SLOPE	187.871	
SIDESHOT 121	HA	381.1899	VA	101.7916	SLOPE	184.360	
SIDESHOT 122	HA	381.8061	VA	101.8346	SLOPE	178.058	
SIDESHOT 123	HA	375.1221	VA	101.6968	SLOPE	175.056	
SIDESHOT 124	HA	377.5853	VA	102.1275	SLOPE	162.897	
SIDESHOT 125	HA	379.1265	VA	101.9901	SLOPE	158.432	
SIDESHOT 126	HA	377.0329	VA	102.1296	SLOPE	147.365	
SIDESHOT 127	HA	377.9548	VA	102.2477	SLOPE	143.924	
SIDESHOT 128	HA	376.7000	VA	102.2735	SLOPE	143.461	
SIDESHOT 129	HA	380.0751	VA	102.3062	SLOPE	141.207	
SIDESHOT 130	HA	380.8920	VA	102.3517	SLOPE	141.169	
SIDESHOT 131	HA	384.2340	VA	101.8426	SLOPE	143.445	TARGET 2.900
REFSTATION 2	HA	117.4433	DESCRIPTION	Steluta	NORTHING	590449.220	EASTING 391928.280
OCCUPIEDSTATION 1	INSTRUMENT	1.619	NORTHING	597689.676	EASTING	390114.466	ELEVATION 351.880
SIDESHOT 3	HA	143.0876	VA	100.4801	SLOPE	172.041	TARGET 1.700
SIDESHOT 4	HA	143.0675	VA	100.4799	SLOPE	172.034	TARGET 1.700
SIDESHOT 5	HA	136.9970	VA	101.0302	SLOPE	169.999	TARGET 1.700
SIDESHOT 6	HA	132.3139	VA	101.4099	SLOPE	173.378	TARGET 1.700
SIDESHOT 7	HA	128.6587	VA	101.6246	SLOPE	182.184	TARGET 1.700
SIDESHOT 8	HA	125.9911	VA	101.4632	SLOPE	156.158	TARGET 1.700
SIDESHOT 9	HA	122.9475	VA	101.5464	SLOPE	149.454	TARGET 1.700
SIDESHOT 10	HA	118.6345	VA	101.8579	SLOPE	147.744	TARGET 1.700
SIDESHOT 11	HA	111.0764	VA	102.3573	SLOPE	146.266	TARGET 1.700
SIDESHOT 12	HA	105.2504	VA	102.7705	SLOPE	147.007	TARGET 1.700
SIDESHOT 13	HA	103.0893	VA	102.9508	SLOPE	147.345	TARGET 1.700
SIDESHOT 14	HA	102.5934	VA	103.0632	SLOPE	149.644	TARGET 1.700
SIDESHOT 15	HA	102.9539	VA	103.0733	SLOPE	151.937	TARGET 1.700
SIDESHOT 16	HA	109.6777	VA	102.6963	SLOPE	169.603	TARGET 1.700
SIDESHOT 17	HA	108.3838	VA	102.6871	SLOPE	173.395	TARGET 1.700
SIDESHOT 18	HA	104.6006	VA	102.6691	SLOPE	163.950	TARGET 1.700
SIDESHOT 19	HA	99.8070	VA	103.1223	SLOPE	152.720	TARGET 1.700
SIDESHOT 20	HA	95.9212	VA	103.3044	SLOPE	145.773	TARGET 1.700
REFSTATION 21	HA	92.4466	DESCRIPTION	Steluta	NORTHING	590449.220	EASTING 391928.280
OCCUPIEDSTATION 1	INSTRUMENT	1.535					
REFSTATION 3	HA	363.9945	DESCRIPTION	Steluta	NORTHING	590449.220	EASTING 391926.250
SIDESHOT 4	HA	220.9253	VA	98.8711	SLOPE	9.269	TARGET 1.700
SIDESHOT 5	HA	210.3690	VA	99.6996	SLOPE	9.366	TARGET 1.700
SIDESHOT 6	HA	197.6074	VA	100.1012	SLOPE	13.937	TARGET 1.700
SIDESHOT 7	HA	172.9271	VA	100.3515	SLOPE	15.108	TARGET 1.700
SIDESHOT 8	HA	157.8562	VA	100.9069	SLOPE	10.145	TARGET 1.700
SIDESHOT 9	HA	230.3539	VA	98.4101	SLOPE	5.964	TARGET 1.700
SIDESHOT 10	HA	31.1112	VA	99.7963	SLOPE	19.024	TARGET 1.700
SIDESHOT 11	HA	33.0153	VA	99.9336	SLOPE	26.421	TARGET 1.700
SIDESHOT 12	HA	40.7701	VA	100.0660	SLOPE	26.633	TARGET 1.700
SIDESHOT 13	HA	23.9515	VA	99.6177	SLOPE	25.099	TARGET 1.700
SIDESHOT 14	HA	23.9536	VA	99.6151	SLOPE	25.093	TARGET 1.700
SIDESHOT 15	HA	20.0397	VA	99.3624	SLOPE	24.898	TARGET 1.700
SIDESHOT 16	HA	32.4995	VA	99.9456	SLOPE	44.946	TARGET 1.700
SIDESHOT 17	HA	33.7066	VA	99.6405	SLOPE	46.767	TARGET 1.700
SIDESHOT 18	HA	37.1409	VA	99.7674	SLOPE	50.717	TARGET 1.700
SIDESHOT 19	HA	33.2972	VA	99.6034	SLOPE	59.410	TARGET 1.700
SIDESHOT 20	HA	30.4297	VA	99.8431	SLOPE	60.626	TARGET 1.700
SIDESHOT 21	HA	28.9623	VA	99.8858	SLOPE	63.716	TARGET 1.700
SIDESHOT 22	HA	24.1271	VA	99.7552	SLOPE	58.977	TARGET 1.700
SIDESHOT 23	HA	22.0096	VA	99.7266	SLOPE	60.099	TARGET 1.700
SIDESHOT 24	HA	20.4134	VA	99.6127	SLOPE	59.906	TARGET 1.700
SIDESHOT 25	HA	25.1157	VA	99.8384	SLOPE	68.634	TARGET 1.700
SIDESHOT 26	HA	20.4646	VA	99.6725	SLOPE	94.916	TARGET 1.700
SIDESHOT 27	HA	21.5666	VA	99.7365	SLOPE	94.956	TARGET 1.700
SIDESHOT 28	HA	26.1364	VA	99.8722	SLOPE	95.582	TARGET 1.700
SIDESHOT 29	HA	24.6706	VA	99.6533	SLOPE	130.369	TARGET 1.700
SIDESHOT 30	HA	21.2765	VA	99.7530	SLOPE	130.080	TARGET 1.700
SIDESHOT 31	HA	20.6384	VA	99.6756	SLOPE	130.051	TARGET 1.700
SIDESHOT 32	HA	23.8973	VA	99.6926	SLOPE	159.696	TARGET 1.700
SIDESHOT 33	HA	24.4981	VA	99.5322	SLOPE	166.471	TARGET 1.700
SIDESHOT 34	HA	25.9564	VA	99.3672	SLOPE	172.730	TARGET 1.700
SIDESHOT 35	HA	21.1610	VA	99.7875	SLOPE	150.927	TARGET 1.700
SIDESHOT 36	HA	20.4669	VA	99.7429	SLOPE	151.064	TARGET 1.700
SIDESHOT 37	HA	20.4679	VA	99.7251	SLOPE	150.935	TARGET 1.700
SIDESHOT 38	HA	19.8073	VA	99.9936	SLOPE	159.201	TARGET 1.700
SIDESHOT 39	HA	19.3181	VA	99.9505	SLOPE	158.318	TARGET 1.700
SIDESHOT 40	HA	19.0495	VA	99.7697	SLOPE	154.701	TARGET 1.700
SIDESHOT 41	HA	19.2446	VA	99.9695	SLOPE	153.423	TARGET 1.700
SIDESHOT 42	HA	18.4748	VA	100.1493	SLOPE	151.403	TARGET 1.700
SIDESHOT 43	HA	17.2214	VA	100.8937	SLOPE	151.155	TARGET 1.700
SIDESHOT 44	HA	17.0065	VA	101.0487	SLOPE	141.763	TARGET 1.700
SIDESHOT 45	HA	11.7755	VA	101.1239	SLOPE	142.607	TARGET 1.700
SIDESHOT 46	HA	12.2936	VA	101.0105	SLOPE	152.094	TARGET 1.700
SIDESHOT 47	HA	11.4659	VA	101.0745	SLOPE	145.640	TARGET 1.700
SIDESHOT 48	HA	11.8962	VA	101.0696	SLOPE	145.481	TARGET 1.700
SIDESHOT 49	HA	18.5287	VA	100.0066	SLOPE	159.982	TARGET 1.700
SIDESHOT 50	HA	18.7997	VA	100.0892	SLOPE	161.692	TARGET 1.700
SIDESHOT 51	HA	18.5865	VA	100.0039	SLOPE	160.181	TARGET 1.700
SIDESHOT 52	HA	16.0335	VA	100.3482	SLOPE	163.700	TARGET 1.700
SIDESHOT 53	HA	16.0310	VA	100.2781	SLOPE	162.133	TARGET 1.700
SIDESHOT 54	HA	12.2610	VA	100.6566	SLOPE	162.382	TARGET 1.700
SIDESHOT 55	HA	12.3658	VA	100.5894	SLOPE	160.826	TARGET 1.700
SIDESHOT 56	HA	8.9434	VA	100.7873	SLOPE	157.246	TARGET 1.700

SIDESHOT 57	HA	9.6029 VA	100.8378 SLOPE	159.569 TARGET	1.700
SIDESHOT 58	HA	5.3286 VA	101.0109 SLOPE	154.377 TARGET	1.700
SIDESHOT 59	HA	5.6183 VA	100.9550 SLOPE	152.901 TARGET	1.700
SIDESHOT 60	HA	397.3009 VA	101.3798 SLOPE	144.788 TARGET	1.700
SIDESHOT 61	HA	397.4910 VA	101.3605 SLOPE	143.507 TARGET	1.700
SIDESHOT 62	HA	394.0209 VA	101.6058 SLOPE	141.631 TARGET	1.700
SIDESHOT 63	HA	394.1416 VA	101.5395 SLOPE	140.072 TARGET	1.700
SIDESHOT 64	HA	391.5232 VA	101.7322 SLOPE	139.287 TARGET	1.700
SIDESHOT 65	HA	391.3524 VA	101.7719 SLOPE	140.901 TARGET	1.700
SIDESHOT 66	HA	366.2329 VA	102.1049 SLOPE	141.389 TARGET	1.700
SIDESHOT 67	HA	366.1686 VA	102.0646 SLOPE	139.854 TARGET	1.700
SIDESHOT 68	HA	361.5203 VA	102.4313 SLOPE	139.660 TARGET	1.700
SIDESHOT 69	HA	381.4191 VA	102.4669 SLOPE	141.218 TARGET	1.700
SIDESHOT 70	HA	375.2569 VA	102.9772 SLOPE	137.765 TARGET	1.700
SIDESHOT 71	HA	375.0454 VA	102.9769 SLOPE	139.290 TARGET	1.700
SIDESHOT 72	HA	371.0976 VA	103.1017 SLOPE	152.176 TARGET	1.700
SIDESHOT 73	HA	375.8522 VA	102.9405 SLOPE	137.690 TARGET	1.700
SIDESHOT 74	HA	368.3343 VA	103.3896 SLOPE	135.138 TARGET	1.700
SIDESHOT 75	HA	368.5143 VA	103.3762 SLOPE	133.635 TARGET	1.700
SIDESHOT 76	HA	365.8258 VA	103.3256 SLOPE	143.125 TARGET	1.700
SIDESHOT 77	HA	362.0080 VA	103.5185 SLOPE	129.587 TARGET	1.700
SIDESHOT 78	HA	362.4125 VA	103.6018 SLOPE	127.946 TARGET	1.700
SIDESHOT 79	HA	349.6583 VA	104.0047 SLOPE	119.302 TARGET	1.700
SIDESHOT 80	HA	348.7351 VA	104.0621 SLOPE	115.645 TARGET	1.700
SIDESHOT 81	HA	348.1420 VA	104.0610 SLOPE	117.258 TARGET	1.700
SIDESHOT 82	HA	323.9169 VA	104.3583 SLOPE	111.420 TARGET	1.700
SIDESHOT 83	HA	323.8554 VA	104.3431 SLOPE	109.551 TARGET	1.700
SIDESHOT 84	HA	324.6507 VA	104.1766 SLOPE	118.354 TARGET	1.700
SIDESHOT 85	HA	324.7165 VA	104.4743 SLOPE	106.506 TARGET	1.700
SIDESHOT 86	HA	324.6935 VA	104.8064 SLOPE	105.855 TARGET	1.700
SIDESHOT 87	HA	324.6766 VA	104.5530 SLOPE	105.010 TARGET	1.700
SIDESHOT 88	HA	323.3299 VA	104.7204 SLOPE	93.424 TARGET	1.700
SIDESHOT 89	HA	318.8167 VA	107.4489 SLOPE	46.001 TARGET	1.700
SIDESHOT 90	HA	309.2928 VA	107.1814 SLOPE	41.134 TARGET	1.700
SIDESHOT 91	HA	317.9844 VA	107.3024 SLOPE	41.756 TARGET	1.700
SIDESHOT 92	HA	316.3647 VA	107.2159 SLOPE	41.630 TARGET	1.700
SIDESHOT 93	HA	313.9549 VA	109.7756 SLOPE	31.692 TARGET	1.700
SIDESHOT 94	HA	313.7757 VA	109.9655 SLOPE	30.936 TARGET	1.700
SIDESHOT 95	HA	312.7716 VA	109.1433 SLOPE	31.084 TARGET	1.700
SIDESHOT 96	HA	294.8176 VA	117.3966 SLOPE	14.844 TARGET	1.700
SIDESHOT 97	HA	297.9558 VA	118.5912 SLOPE	13.791 TARGET	1.700
SIDESHOT 98	HA	282.9319 VA	113.9731 SLOPE	18.169 TARGET	1.700
SIDESHOT 99	HA	260.4621 VA	114.7387 SLOPE	17.316 TARGET	1.700
SIDESHOT 100	HA	277.8077 VA	115.3123 SLOPE	16.681 TARGET	1.700
SIDESHOT 101	HA	265.7100 VA	116.1669 SLOPE	14.053 TARGET	1.700
SIDESHOT 102	HA	275.4414 VA	116.0577 SLOPE	12.247 TARGET	1.700
SIDESHOT 103	HA	271.2470 VA	117.4997 SLOPE	11.170 TARGET	1.700
SIDESHOT 104	HA	266.5718 VA	119.0303 SLOPE	10.341 TARGET	1.700
SIDESHOT 105	HA	263.0015 VA	117.8472 SLOPE	12.053 TARGET	1.700
SIDESHOT 106	HA	261.6348 VA	119.0712 SLOPE	10.666 TARGET	1.700
SIDESHOT 107	HA	325.1623 VA	129.5236 SLOPE	7.062 TARGET	1.700
SIDESHOT 108	HA	371.7164 VA	119.9814 SLOPE	10.196 TARGET	1.700
SIDESHOT 109	HA	366.3793 VA	118.4063 SLOPE	10.983 TARGET	1.700
SIDESHOT 110	HA	364.3613 VA	122.0511 SLOPE	10.095 TARGET	1.700
SIDESHOT 111	HA	345.2732 VA	111.8462 SLOPE	20.213 TARGET	1.700
SIDESHOT 112	HA	317.0936 VA	109.2199 SLOPE	30.889 TARGET	1.700
SIDESHOT 113	HA	332.6762 VA	106.3442 SLOPE	58.561 TARGET	1.700
SIDESHOT 114	HA	324.3957 VA	105.4376 SLOPE	77.964 TARGET	1.700
SIDESHOT 115	HA	331.7385 VA	104.6611 SLOPE	102.671 TARGET	1.700
SIDESHOT 116	HA	337.4693 VA	104.4666 SLOPE	106.028 TARGET	1.700
SIDESHOT 117	HA	337.1758 VA	104.4201 SLOPE	107.453 TARGET	1.700
SIDESHOT 118	HA	337.8470 VA	104.7151 SLOPE	107.095 TARGET	1.700
SIDESHOT 119	HA	350.7268 VA	104.1147 SLOPE	113.564 TARGET	1.700
SIDESHOT 120	HA	351.0599 VA	104.1947 SLOPE	112.197 TARGET	1.700
SIDESHOT 121	HA	350.4248 VA	104.4292 SLOPE	112.783 TARGET	1.700
SIDESHOT 122	HA	354.6925 VA	104.2630 SLOPE	109.717 TARGET	1.700
SIDESHOT 123	HA	358.0317 VA	105.0274 SLOPE	85.719 TARGET	1.700
SIDESHOT 124	HA	377.8378 VA	104.7012 SLOPE	75.829 TARGET	1.700
SIDESHOT 125	HA	387.1603 VA	105.3989 SLOPE	51.471 TARGET	1.700
SIDESHOT 126	HA	11.0543 VA	103.6567 SLOPE	59.058 TARGET	1.700
SIDESHOT 127	HA	12.4016 VA	103.6731 SLOPE	56.941 TARGET	1.700
SIDESHOT 128	HA	11.8085 VA	103.9037 SLOPE	60.062 TARGET	1.700
SIDESHOT 129	HA	14.0411 VA	103.0330 SLOPE	73.312 TARGET	1.700
SIDESHOT 130	HA	14.8973 VA	102.5562 SLOPE	87.673 TARGET	1.700
SIDESHOT 131	HA	14.0672 VA	102.5411 SLOPE	88.036 TARGET	1.700
SIDESHOT 132	HA	14.5409 VA	102.7390 SLOPE	89.704 TARGET	1.700
SIDESHOT 133	HA	8.3780 VA	102.8026 SLOPE	93.750 TARGET	1.700
SIDESHOT 134	HA	387.2537 VA	103.9054 SLOPE	91.069 TARGET	1.700
SIDESHOT 135	HA	379.1458 VA	103.6955 SLOPE	117.176 TARGET	1.700
SIDESHOT 136	HA	366.2743 VA	103.6021 SLOPE	130.169 TARGET	1.700
SIDESHOT 137	HA	368.1549 VA	103.5868 SLOPE	131.315 TARGET	1.700
SIDESHOT 138	HA	368.5485 VA	103.7268 SLOPE	131.138 TARGET	1.700
SIDESHOT 139	HA	373.1103 VA	103.4985 SLOPE	132.970 TARGET	1.700
SIDESHOT 140	HA	372.8621 VA	103.4666 SLOPE	134.014 TARGET	1.700
SIDESHOT 141	HA	376.1796 VA	103.3690 SLOPE	135.797 TARGET	1.700
SIDESHOT 142	HA	378.1740 VA	103.4127 SLOPE	134.589 TARGET	1.700
SIDESHOT 143	HA	376.6054 VA	103.4920 SLOPE	135.353 TARGET	1.700
SIDESHOT 144	HA	383.2326 VA	103.1959 SLOPE	134.878 TARGET	1.700
SIDESHOT 145	HA	383.2169 VA	103.1724 SLOPE	136.137 TARGET	1.700

SIDESHOT 146	HA	390.2149	VA	102.9155	SLOPE	134.192	TARGET	1.700
SIDESHOT 147	HA	390.2046	VA	102.8956	SLOPE	135.357	TARGET	1.700
SIDESHOT 148	HA	389.8096	VA	103.0655	SLOPE	134.762	TARGET	1.700
SIDESHOT 149	HA	390.4768	VA	103.1222	SLOPE	124.202	TARGET	1.700
SIDESHOT 150	HA	392.7751	VA	103.2237	SLOPE	114.864	TARGET	1.700
SIDESHOT 151	HA	1.3839	VA	102.7961	SLOPE	115.168	TARGET	1.700
SIDESHOT 152	HA	3.0972	VA	102.2191	SLOPE	141.389	TARGET	1.700
SIDESHOT 153	HA	3.0961	VA	102.2167	SLOPE	142.497	TARGET	1.700
SIDESHOT 154	HA	3.2852	VA	102.3428	SLOPE	141.917	TARGET	1.700
SIDESHOT 155	HA	9.2310	VA	101.9536	SLOPE	136.289	TARGET	1.700
SIDESHOT 156	HA	9.3382	VA	101.9371	SLOPE	139.529	TARGET	1.700
SIDESHOT 157	HA	16.6211	VA	101.7190	SLOPE	137.362	TARGET	1.700
SIDESHOT 158	HA	16.1399	VA	101.7191	SLOPE	136.466	TARGET	1.700
SIDESHOT 159	HA	16.4006	VA	101.8546	SLOPE	135.910	TARGET	1.700
SIDESHOT 160	HA	16.9053	VA	101.0319	SLOPE	140.399	TARGET	1.700
SIDESHOT 161	HA	11.3067	VA	101.1755	SLOPE	142.471	TARGET	1.700
SIDESHOT 162	HA	2.4795	VA	101.2091	SLOPE	146.246	TARGET	1.700
SIDESHOT 163	HA	10.4085	VA	100.8004	SLOPE	154.625	TARGET	1.700
SIDESHOT 164	HA	14.1319	VA	100.4497	SLOPE	155.952	TARGET	1.700
SIDESHOT 165	HA	17.3955	VA	100.3395	SLOPE	154.679	TARGET	1.700
SIDESHOT 166	HA	19.4093	VA	99.8871	SLOPE	152.223	TARGET	1.700
REFSTATION 167	HA	225.6835	VA	100.8115	SLOPE	137.671	TARGET	1.700
389976.859 ELEVATION 349.965								
OCCUPIEDSTATION 167	INSTRUMENT 1.303 NORTHING 587656.163 EASTING 389976.859 ELEVATION 349.965							
REFSTATION 1	HA	354.1696	VA	98.9348	SLOPE	137.672	TARGET	1.700
REFSTATION 168	HA	0.1527	DESCRIPTION TT NORTHING 587271.010 EASTING 390437.380					

D&M TOPOGRAFIE

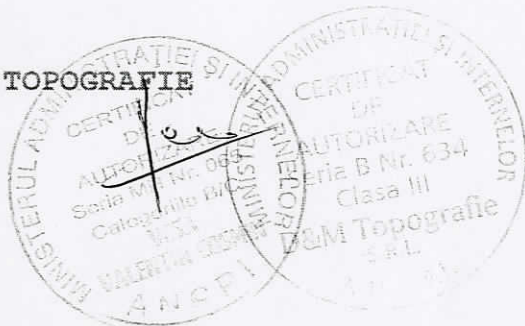

CALCULUL ANALITIC AL SUPRAFETELOR

SISTEM DE PROIECTIE " STEREOGRAFIC 70 "

SITUATIA ACTUALA

Parcela (3)

Nr. Pct.	Coordonate pct.de contur		Lungimi laturi D(i,i+1)
	X [m]	Y [m]	
23	587765.992	389785.448	128.475
14	587637.523	389784.202	40.365
15	587637.112	389824.565	128.737
22	587765.842	389825.950	40.502
S (3)=5200mp P=338.080m			

Parcela (2)

Nr. Pct.	Coordonate pct.de contur		Lungimi laturi D(i,i+1)
	X [m]	Y [m]	
21	587765.620	389885.950	60.000
22	587765.842	389825.950	128.737
15	587637.112	389824.565	60.998
16	587636.490	389885.560	129.131
S (2)=7800mp P=378.867m			

SITUATIA VIITOARE

Parcela (1)

Nr. Pct.	Coordonate pct.de contur		Lungimi laturi D(i,i+1)
	X [m]	Y [m]	
23	587765.992	389785.448	40.502
22	587765.842	389825.950	60.000
21	587765.620	389885.950	129.131
16	587636.490	389885.560	60.998
15	587637.112	389824.565	40.365
14	587637.523	389784.202	128.475
S (1)=13000.29mp P=459.472m			

Executant,
D&M TOPOGRAFIE
B. 634



Data